

SPECIFICATION	CONNECTION	VALUE
GEAR RATIO		100
EFFICIENCY		94.00%
BACKLASH@NO-LOAD(arcmin)		<=20
MAX.PERMISSIBLE TORQUE(Nm)[lb-in]		10.00[88.51]
MOMENT PERMISSIBLE TORQUE(Nm)[lb-in]		20.00[177.01]
GEARBOX MATCHING MOTOR'S INPUT SHAFT LENGTH (mm)		24
NOISE(dB)		<=55
WATERPROOF RATING		IP54
LIFE(h)		20000
AMBIENT TEMPERATURE		-10°C~90°C[14°F~194°F]

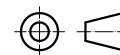

	APVD	3.2.2021
	CHKD	
1:1	DRN	
SCALE	SIGNATURE	DATE

PLANETARY GEARBOX

TQEG17-G100